

SLIDING DOOR SYSTEMS: CONSTRUCTION MANUAL

SLIDING DOOR SERIES 751

ACCESSORIES:

5th edition Bremen, January 2006

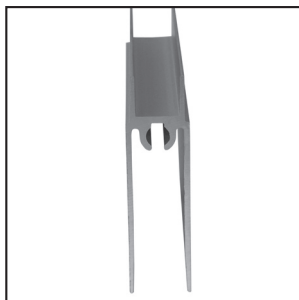

1_

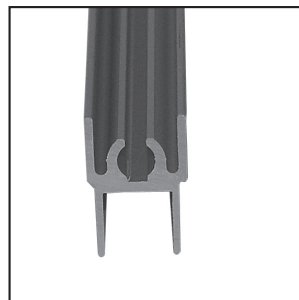

2_

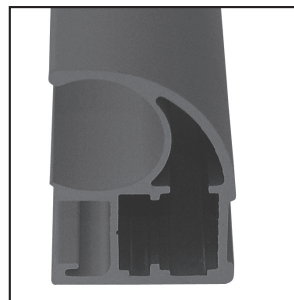

3_



4_

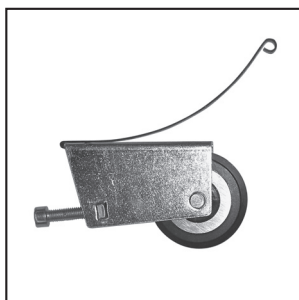

5_

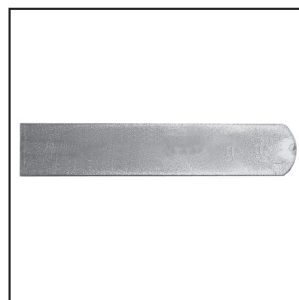

6_



7_

1_Bottom rail (15.04.0xx)_forms the frame for the door together with the vertical and top horizontal profile.

2_Top rail (15.12.0xx)_forms the frame for the door together with the vertical and bottom horizontal profile.

3_Stile S751 (15.11.0xx)_a left and a right profile is used for each door. In order to fasten the horizontal profiles, two bo-rings are made in the bottom of the profile and one in the top.

4_Top roller (10.01.018)_is fit into the top of the vertical profile.

5_Bottom roller with anti-jump spring (10.01.020)_is pushed into the bottom horizontal profile.

6_Plugs (10.07.0xx)_to cover the drill holes. Is needed only during the final installation.

7_Frame screw (15.07.012)_to fasten the vertical profiles to the horizontal profile.

_Allen key 4 mm_to adjust the bottom roller (height adjustment).

_Allen key 5 mm_to tighten the frame screw.

You will also need:

_Rubber mallet_to fasten the profile to the panel.

_Cutter or blade_to cut the corners of the gaskets (if needed).

_Gasket (accessory)_for panels up to 8 mm (10 mm panels do not require a gasket). Ask your supplier.

_Dust excluding brush (accessory)_to seal the crevices (spaces) between the door and the wall and between doors. Ask your supplier. **The dust excluding brush is needed only during the final installation.**

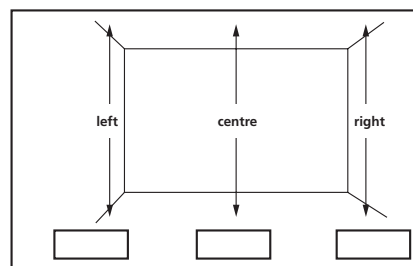
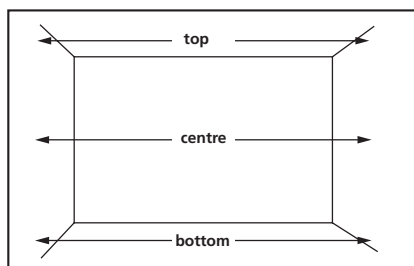

If you do not have a pre-cut panel, you have to measure the width and height exactly. Please take the dimensions from the measurement instructions.

leicht

mittel

anspruchsvoll*

Fertigung

raumplus

*Bezugsgröße für den Schwierigkeitsgrad ist eine Standardgleittür ohne Schräge.
Diese ist mit „leicht“ in der Fertigung und im Aufbau einzustufen.

_PREPARATION / INSTALLATION

PREPARATION:

After you have decided on a panel material you may begin with the installation. With wood panels you begin directly with the assembly; with a glass or mirror door you need a gasket. Please note the thickness of the door panel in order to select the correct gasket (panel thickness 4 to 8 mm).

INSTALLATION:

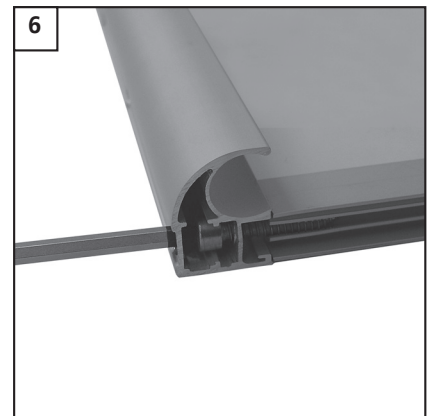
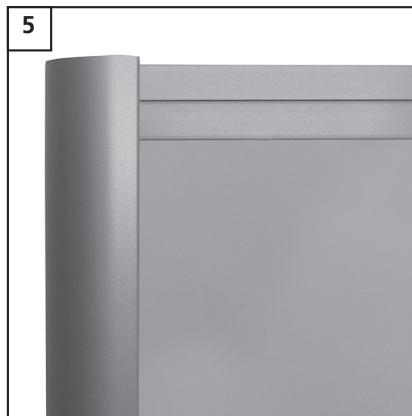
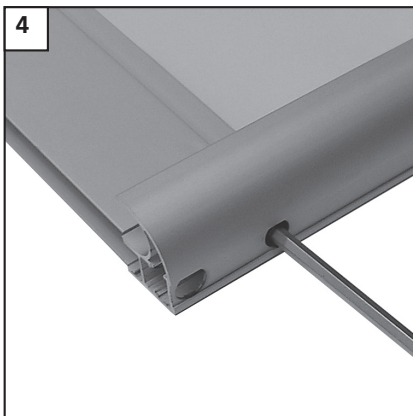
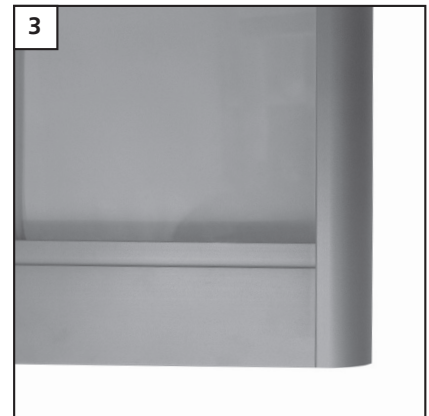
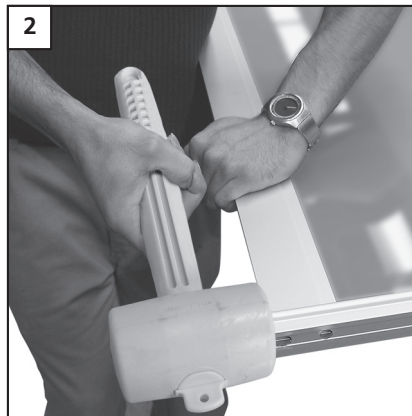
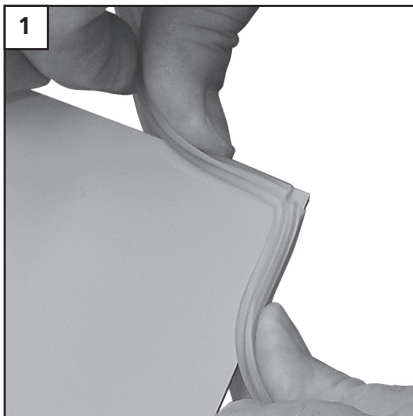

2_Lay the door panel on the assembly table with the back facing downwards.

1_The gasket must be stretched taut around the panel. To do this you should begin in the centre of the top horizontal profile. For the corner, cut an approx. 2 mm deep nick into the gasket and stretch the gasket over the corner (picture **1**).

3_Begin with the bottom horizontal profile. Apply it so that there is an equal distance left and right (approx. 6-7 mm). Do the same with the top horizontal profile.

4_You must pay attention with the vertical profiles that they provide a right and left vertical profile. The side with the double punched holes belongs on the bottom (picture **4** and **6**).

5_Now hit the vertical profile on the panel with the rubber mallet so that it closes directly with the horizontal profile (picture **3** and **5**). Also align the vertical profile with a straight bar (straightedge striker). Screw together using the frame screws. Please notice that on the bottom horizontal profile there are two punched holes and use the top punch hole (picture **4**).

_INSTALLATION OF THE FITTINGS

FITTINGS:

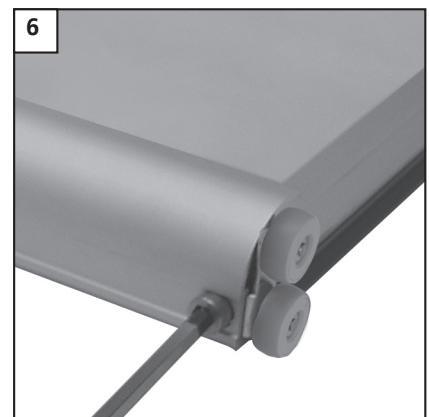
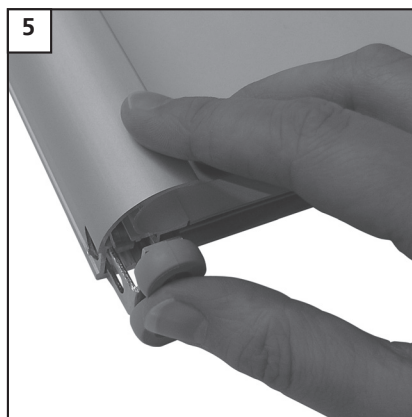
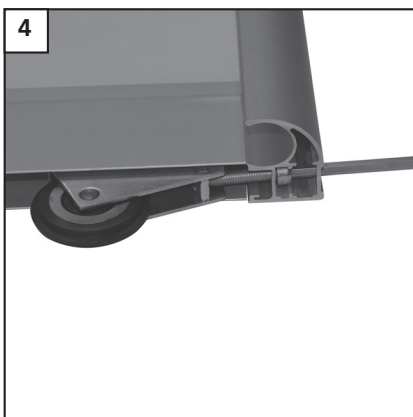
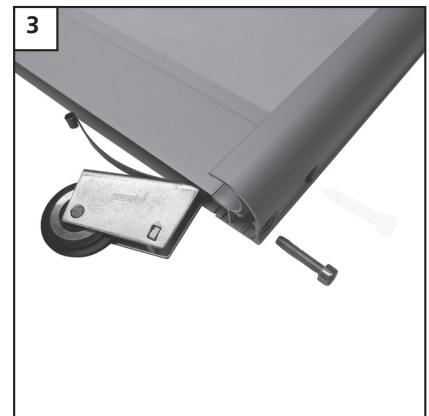
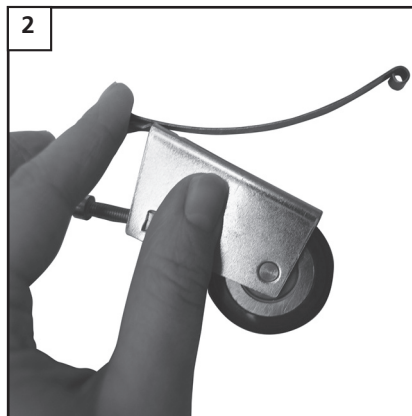
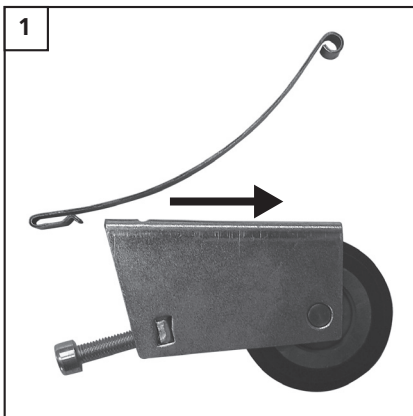

1_Attach the anti-jump springs to the roller (picture **1** and **2**).

2_Put the bottom roller into the bottom horizontal profile and screw the thread screw through the bottom boring into the roller so that it is attached (picture **4**). The roller is adjustable using the screw.

3_With the top horizontal profile you screw the screws in completely in order to widen the screw thread, and then unscrew a bit so that the top rollers can be pushed in (picture **5**).

4_At the end push the top roller into the top of the vertical profile (picture **5**) and screw it in tightly (picture **6**).

_DETAIL DRAWING

