

SLIDING DOOR SYSTEMS: INSTALLATION INSTRUCTIONS

TOP TRACK POSITIONING

ACCESSORIES:

1st Edition_August 2006

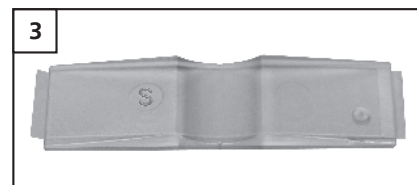
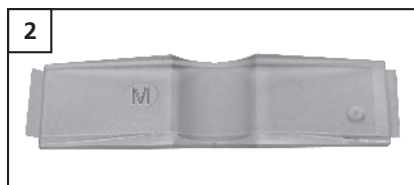
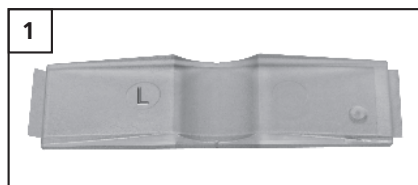

Top track positioning: 1_light (L) up to approx. 25 kg (10.09.230), / 2_medium (M) between approx. 20 - 35 kg (10.09.030), / 3_strong (S) between approx. 30 - 45 kg (10.09.130)

ASSEMBLY INSTRUCTIONS:

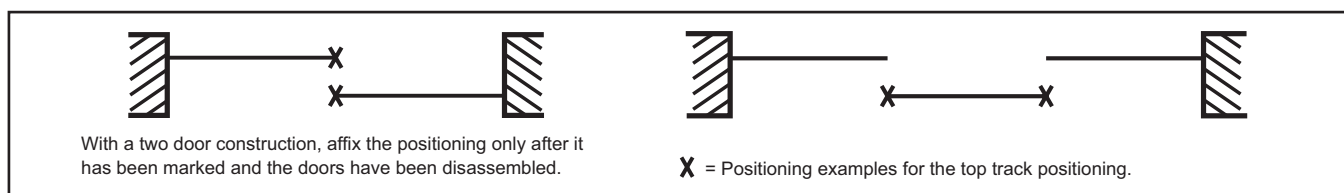

Preparation: After installing and aligning, bring the sliding door into the correct position. Clean the surface for adhesion. The surface where the adhesive is to be put must be dry and free of grease, oil, and silicone residues as well as dust and dirt particles. Bend the protective paper of the positioning towards the rear.

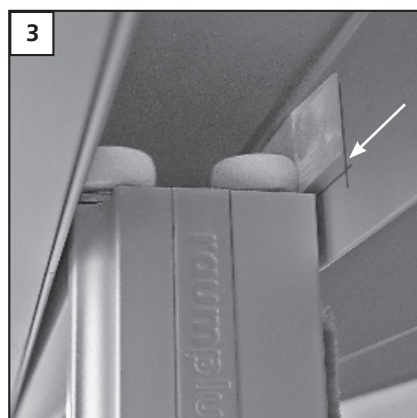
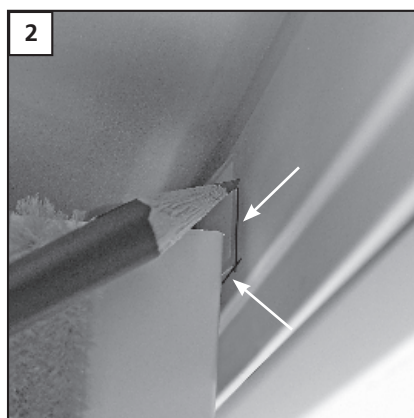
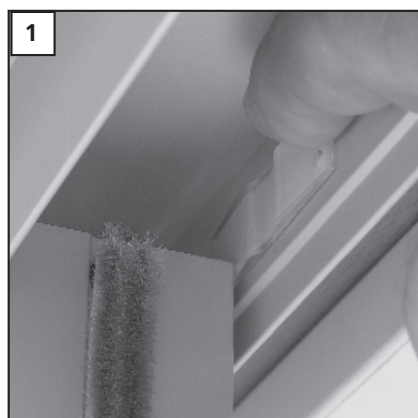

1_Place the top track positioning in front of the top door roller and roll the door into the round recess of the top track positioning. Now bring both together into the closed position.

2_Mark the position of the top track positioning on two sides in the top track. To extract, hold the positioning and open the door.

3_Remove the protective paper from the adhesive surface completely and position it on the marked area (paying attention that the location of the positioning is 2 mm over the top door edge) and press (ca. 20N/cm²). Conduct a function test and afterwards position the sliding door roller on the top track positioning and wait for adherence.

Notice: The higher the temperature, the faster the adherence (20 minutes, 20°C = 50% adherence; 60 minutes, 65°C = 100% adherence; 72 hours, 20°C = 100% adherence).

Warning: With an unfavorable installation setting such as diagonally slanted ceilings or bottom tracks, the top track positioning must be attached at the highest point. If the holding force is too low after the **L** top track positioning has been installed, it can be supplemented with a second one or replaced with a stronger **M** or **S** top track positioning. Since the adherence begins immediately after the installation, the replacement should be made quickly.

easy

medium

difficult

Manufacturing



raumplus

*Base for the degree of difficulty is a standard sliding door without slant. This is to be classified as "easy" in respect of production and installation.