

# SLIDING DOOR SYSTEMS: ASSEMBLY INSTRUCTIONS

## HANDLE S300 AND S3000

### ACCESSORIES:

5<sup>th</sup> edition Bremen, January 2006



1\_



2\_



3\_

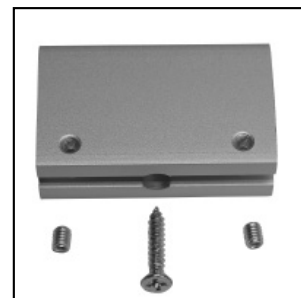

4\_

**1\_ Asymmetrical vertical profile (15.51.0xx S300 / 13.51.0xx S3000) and 2\_ Symmetrical (15.61.0xx S300 / 13.61.0xx S3000)**\_borders the door panel.

**3\_ Handle (14.30.0xx)**\_is attached to the vertical profile with the fastener

**4\_ Handle fastener S300 / S3000 (10.04.020)**\_attaches the handle to the vertical profile

**5\_ Cover plugs for handle (10.04.0xx)**\_seals the ends of the handle

**NOTICE:** Please use the included screws.



5\_

### ASSEMBLY INSTRUCTIONS:

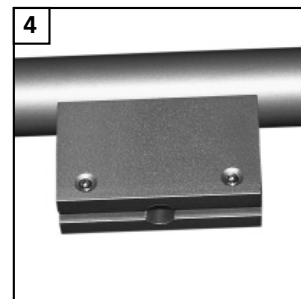
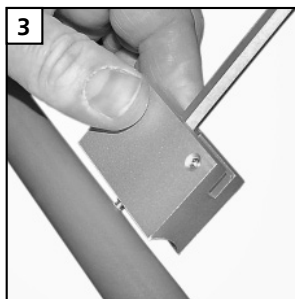
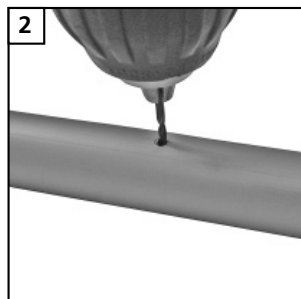
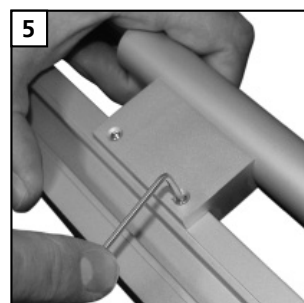
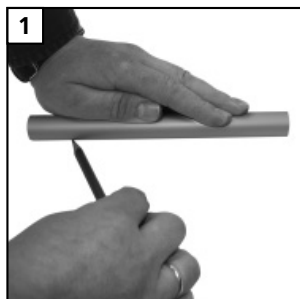

Before the vertical profile is installed, the handle must be attached to the vertical profile first.

**1\_**First, draw marks on the handle where the fastener should be attached. Thereby the marks must be in one line. The simplest way to do this is to lay the handle on an even surface and then draw a line with a pencil across the surface to keep the line straight (picture **1**). Make sure you hold the handle in place while you draw the line. Then drill on the marked position with a 3,0 – 3,2 mm drill and put the fastener against it (picture **2**).

**2\_**Next, screw the fastener on tight as shown in picture **3+4**.

**3\_**Place the fastener against the vertical profile and tighten the set screws carefully with the Allen wrench (here you do not need pre-drilled holes, picture **5**). The handle can be attached on both sides, except with door overlaps and corner solutions.

easy

medium

difficult\*

Manufacturing



**raumplus**

\*Base for the degree of difficulty is a standard sliding door without slant. This is to be classified as ,easy' in respect of production and installation.

# DETAIL DRAWING

## NUMBER OF HANDLE FASTENERS

